

PN Series

Clamp is designed for mounting KT-20 & KT-21 series sensor on round cylinder.

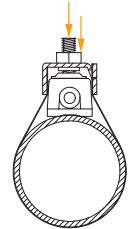
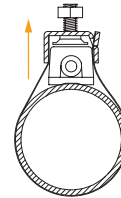
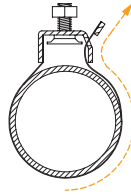
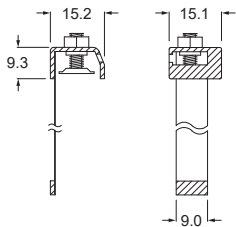

How to Mount

1 Step 1

Loosen screw & nut.

2 Step 2

Wrap the band around the cylinder & put the apex through the fastening hole.

3 Step 3

Pull up mounting head & place sensor under the mounting head.

4 Step 4

Swivel set screw to tighten band and fixing sensor. Finally swivel nut for steadying.

Cylinder Chart

Model	Bore Size	Barrel Material	Model	Bore Size	Barrel Material
PN-A16	Ø16	Aluminum	PN-S10	Ø10	Stainless
PN-A20	Ø20	Aluminum	PN-S12	Ø12	Stainless
PN-A25	Ø25	Aluminum	PN-S16	Ø16	Stainless
PN-A30	Ø30	Aluminum	PN-S20	Ø20	Stainless
PN-A32	Ø32	Aluminum	PN-S25	Ø25	Stainless
PN-A40	Ø40	Aluminum	PN-S32	Ø32	Stainless
PN-A50	Ø50	Aluminum	PN-S40	Ø40	Stainless
PN-A63	Ø63	Aluminum			

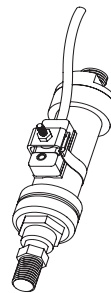

P N - S 2 0

Barrel Material

S : Stainless steel
A : Aluminum alloy

Bore Size

10 : Ø10 round cylinder
12 : Ø12 round cylinder
...
40 : Ø40 round cylinder

PH Series

Clamp is designed for mounting KT-20 & KT-21 series sensor on round cylinder.

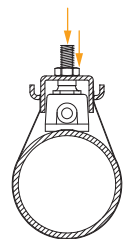
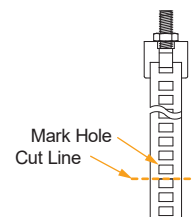
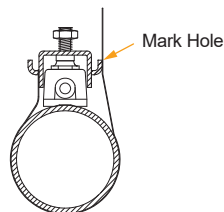
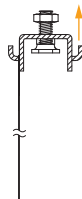
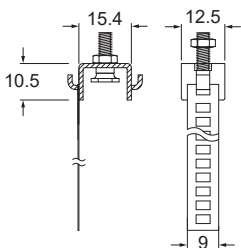

How to Mount

1 Step 1

Loosen screw & nut.

2 Step 2

Place sensor & wrap the band around the cylinder. Position the hook with the nearest hole on the band and mark the hole with a permanent marker.

3 Step 3

Remove mounting assembly. Cut the band at the nearest edge of next hole. (the one that's further away from the mounting head).

4 Step 4

Re-place the sensor & mounting assembly. Wrap the band & put the chosen hole on hook. Position the switch and tighten. Finally swivel nut for steadying.

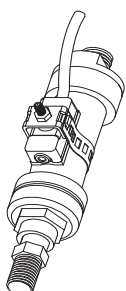

P H - 1

Band No.

1 : For Ø6 ~ Ø63 round cylinder use.
2 : For Ø6 ~ Ø125 round cylinder use.