

BP Clamp

Clamp is designed for mounting KT-1000D on round cylinder.

How To Mount

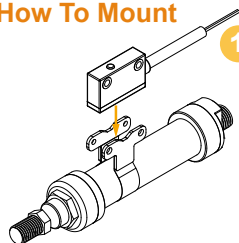

1 Step 1

Wrap the band around cylinder, and place sensor on cylinder.

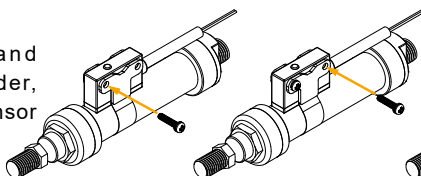

2 Step 2

Insert screw into clamp. Adjust sensor to the sensing position and tighten.

B P - 4 0 4 5

Cylinder I.D.

40 : Ø40 round cylinder
50 : Ø50 round cylinder
63 : Ø63 round cylinder

Cylinder O.D.

45 : Ø45 round cylinder
47 : Ø47 round cylinder
⋮
72 : Ø72 round cylinder

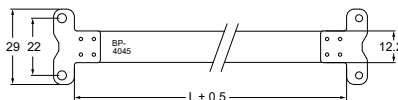

Cylinder Chart

MODEL	" L "	I.D.	O.D.
BP-4045	154	Ø40	Ø45
BP-4047	161	Ø40	Ø47
BP-5055	188	Ø50	Ø55
BP-5058	197	Ø50	Ø58
BP-6368	228	Ø63	Ø68
BP-6372	240	Ø63	Ø72

Unit : mm

PMB Bracket

Bracket is designed for mounting KT-1000D on round cylinder.

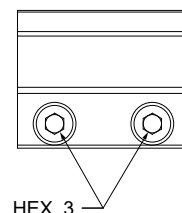
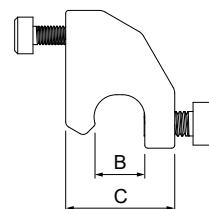
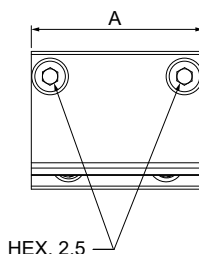
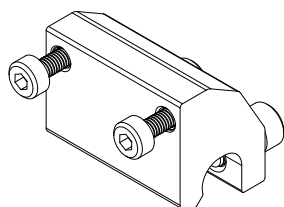
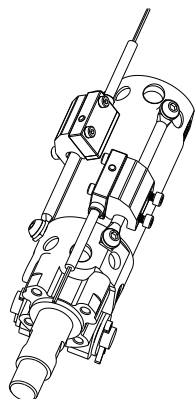

MODEL	DIM.	A	B	C
PMB-040		28.15	8.15	17.85

Unit : mm

Application Environment



- KT-1000D can be applied in the strong magnetic field environment such as automotive manufacturing or areas near welding machine.
- When KT-1000D detects the magnetic AC field (50 or 60 Hz), it will keep the status of output without being affected.

Weld-Field Immune

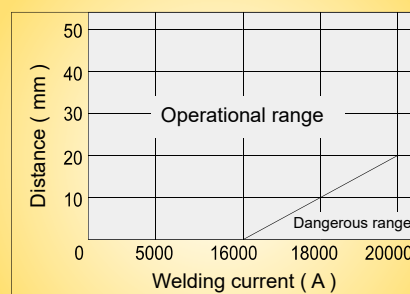

- The operational distance can be 0 mm between KT-1000D and welding gun (welding conductor or cable) when the welding current less than 16000 A.