

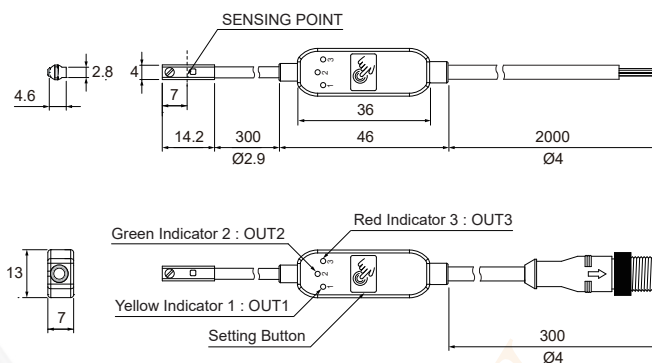

Dimensions

KLG-3N, KLG-3P / KLG-3N-QD, KLG-3P-QD



M12 QD Pinout

■ QD

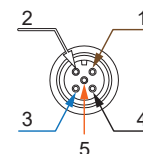

- 1 : Brown (+)
- 2 : White (OUT2)
- 3 : Blue (-)
- 4 : Black (OUT1)
- 5 : Orange (OUT3)

Unit : mm

Specifications

MODEL	KLG-3N	KLG-3P
Connect Diagram		
Characteristics		
Sensing Range ※1	50 mm	
Switching Logic	Solid State Output, Normally Open / Normally Close Switchable	
Sensor Type	3 NPN Current Sinking	3 PNP Current Sourcing
Power Supply Voltage	5 ~ 30 V DC	
Switching Current ※2	150 mA max.	
Supply Voltage ※2	30 V DC	
Contact Rating ※2	4.5 W max.	
Current Consumption	20 mA @ 24 V DC max.	
Voltage Drop ※2	1.5 V max. (with resistive load)	
Leakage Current	0.01 mA max.	
Repeatability	≤ 0.01 mm	
Indicator	Yellow LED, Green LED, Red LED	
Lead Wire	Ø4 PVC - 26 AWG (0.15mm ²) - 5 cores	
Operating Frequency	50 Hz	
Magnet Requirement ※3	40 ~ 1000 Gauss	
Temperature Range	-10 ~ 70 °C	
Shock ※4	50 G	
Vibration ※5	9 G	
Enclosure	IEC 60529 IP69	
Protection Circuit ※6	2, 3, 4	

NOTE

- ※1 : The difference of magnetism, environment, and interference of magnetic field can cause the deviation of measurement.
- ※2 : The standard is for each output
- ※3 : Measuring standard target : ø15.5 × ø8 × 5t (Anisotropy rubber magnet)

- ※4 : Sin wave / X , Y , Z 3 directions / 3 times each direction / 11 ms each time.
- ※5 : Double amplitude 1.5 mm / 10 Hz ~ 55 Hz ~ 10 Hz (Sweep 1 min) / X , Y , Z 3 directions / 1 hour each time.
- ※6 : 1 = None / 2 = Short-circuit / 3 = Power Source Reverse polarity / 4 = Surge Suppression

Groove Dimensions

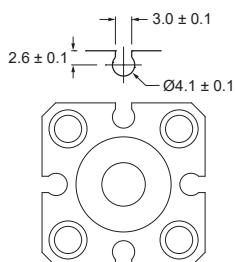

Unit : mm